



12 Brisbane Street Riverstone NSW

4 2 2

This executive single-level Beechwood Home offers a wide frontage and boasts street appeal. This home is located on a 557m2 block and boasts all amenities set up in today's modern homes.

Due to the large frontage, this can be an advantage to any type of buyer should future planning development amendments occur like in Schofields in 2021.

Some of the additional extras on offer include the low-maintenance fully fenced yard, enclosed entertainment area, and newly renovated kitchen.

Inclusions:

* 4 bedrooms with built-in robes

[For full version visit the website](https://www.hometownpropertypartners.com.au/sale/nsw/western-sydney/riverstone/residential/house/8115796)

Type : House
Price : \$1,050,000
Land Size : 557 sqm
View : <https://www.hometownpropertypartners.com.au/sale/nsw/western-sydney/riverstone/residential/house/8115796>



Paula Pender
0408 600 543

12 Brisbane Road, Riverstone

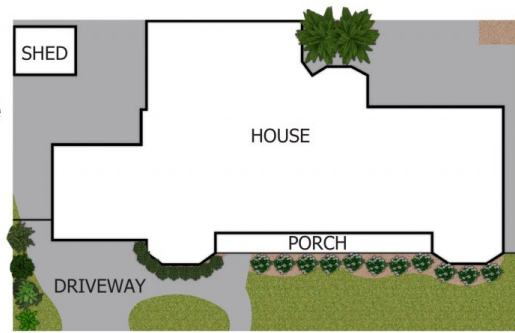

SITE PLAN



(NOT IN POSITION)

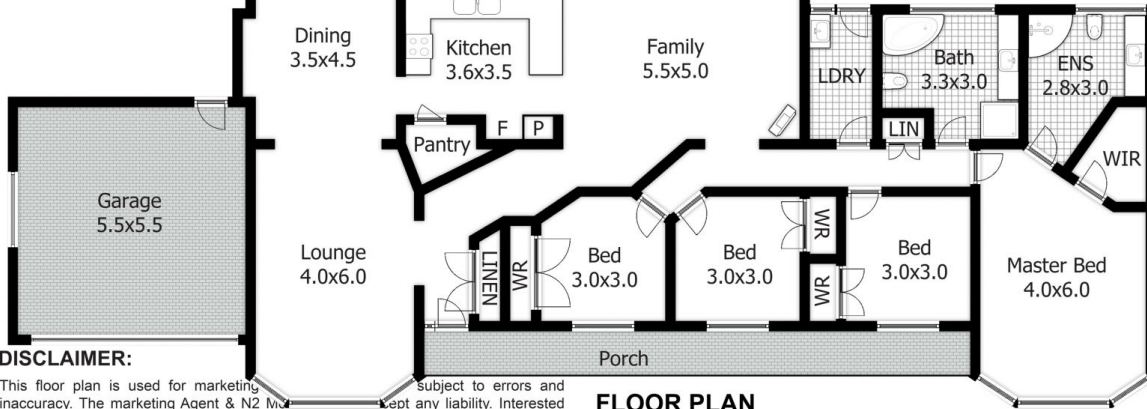

FLOOR PLAN

DISCLAIMER:

This floor plan is used for marketing purposes only and is not intended to be a contract. It is subject to errors and omissions. The marketing Agent & N2 Marketing Pty Ltd accept no liability. Interested parties should make and rely on their own enquiries.

